



ESTABLISHED 1850

TREE REMOVAL PERMIT (STREET TREES OR HERITAGE TREES)

(Please Print)

Property Owner/Applicant: _____

Address of Project Site: _____

E-MAIL address: _____ Phone: _____

Is applicant the owner of the property for which this permit is requested? Yes No

If NO, give name of Authorized Agent.

Name of Authorized Agent: _____ Phone: _____

Address: _____

Street address of property on which tree is located: _____

Tree species, size, and location of tree to be removed: _____

Reason for tree removal: _____

It is acknowledged that, if required as a condition of approval of this permit application, I will provide a replacement tree pursuant to Section 14.09.131.030.B(6) of the Vacaville Land Use and Development Code, within six (6) months of removal as per the planting requirements on the reverse side of this form.

Applicant's Signature Mailing Address Date

FOR PLANNING DIVISION USE ONLY

ACTION: Approved Denied Replant in 6 months

Date: _____

PEYMAN BEHVAND, City Planner

ADDITIONAL CONDITIONS: _____

RECOMMENDED TREE LIST

BOTANICAL NAME	COMMON NAME	TYPE*	GROWTH RATE	HEIGHT	WIDTH	WATER** USE	COMMENTS		
							+	/	-
Albizia julibrissin	Mimosa or Silk Tree	D	Rapid	35'	50'	H	Pink Flowers	/	messy (twiggy)
Betula pendula	European White Birch	D	Rapid	40'	20'	H	White bark on trunk	/	short life
Calocedrus decurrens	Incense Cedar	E	Slow	75'	40'	M	Fragrant foliage	/	wide base
Catalpa speciosa	Western Catalpa	D	Moderate	70'	40'	M	White flowers, bean pod fruits		
Cedrus atlantica 'Glauca'	Blue Atlas Cedar	E	Slow	65'	30'	L	Beautiful blue color	/	well drained
Cedrus deodara	Deodar Cedar	E	Rapid	80'	40'	L	Long life	/	will over power small area
Celtis occidentalis	Common Hackberry	D	Moderate	50'	50'	L	Takes wind, heat, drought		
Ceratonia siliqua	Carob or St. John's Bread	E	Slow	40'	40'	L	Long life	/	Pods can be messy
Cercis occidentalis	Western Redbud	D	Moderate	18'	15'	L	Magenta flowers, fussy to start		
Cinnamomum camphora	Camphor Tree	E	Slow	50'	60'	M	Beautiful tree	/	messy, large roots
Fagus sylvatica	European Beech	D	Moderate	40'	30'	M	Many varieties with purple foliage		
Fraxinus oxycarpa 'Raywood'	Raywood Ash	D	Rapid	35'	35'	M	Watch for too narrow crotches		
Ginkgo biloba	Maidenhair Tree	D	Slow	70'	60'	M	Good fall color, plant only male tree		
Gleditsia tricanthos 'Inermis'	Thornless Locust	D	Rapid	75'	70'	L	Tolerates poor soils, some pod mess		
Koelreuteria paniculata	Golden Rain Tree	D	Slow to Mod.	30'	20'	L	Yellow flowers, takes poor soils		
Lagerstroemia indica	Crape Myrtle	D	Slow	25'	20'	L	Very showy summer flowers		
Laurus nobilis	Sweet Bay	E	Slow	40'	20'	L	Leaf uses in cooking, small tree		
Liquidambar styraciflua	Sweet Gum or Liquid Amber	D	Moderate	40'	25'	M	Fall color	/	spiny fruit ball are messy
Liriodendron tulipifera	Tulip Tree	D	Moderate	70'	35'	H	Fall color, aphids can cause problems		
Magnolia grandiflora	Southern Magnolia	E	Slow	60'	50'	H	Big white flowers	/	very slow growing
Olea europaea 'Swan Hill'	Fruitless Olive	E	Slow	30'	20'	L	Plant only this fruitless variety		
Pinus canariensis	Canary Island Pine	E	Rapid	80'	35'	M	Long needles	/	gawky when young
Pinus pinea	Italian Stone Pine	E	Moderate	80'	60'	L	Vary large, need lots of room		
Pinus halepensis	Aleppo Pine	E	Rapid	60'	40'	L	Irregular Shape, takes pruning well		
Pistachia chinensis	Chinese Pistache Tree	D	Slow	60'	60'	L	Fall color, takes all soils		
Platanus x acerfolia 'Bloodgood'	London Plane Tree	D	Rapid	80'	50'	M	Great shade, big leaves	/	some diseases
Prunus cerasifera 'Atropurpurea'	Purple Leaf Plum	D	Moderate	25'	15'	M	White spring flowers, purple leaves		
Pyrus calleryana 'Aristocrat'	Aristocrat Pear	D	Moderate	40'	20'	M	More pyramidal, up curving limbs		
Pyrus calleryana 'Bradford'	Bradford Pear	D	Moderate	40'	20'	M	White spring flowers, horizontal limbs		
Quercus agrifolia	Coast Live Oak	E	Moderate	75'	95'	L	Native, low water use, eventually large		
Quercus lobata	Valley Oak	D	Moderate	70'	70'	L	Native	/	needs lots of room, messy
Quercus palustius	Pin Oak	D	Rapid	80'	40'	M	Good lawn tree	/	dead leaves persist
Quercus suber	Cork Oak	E	Moderate	65'	40'	M	Interesting bark	/	bark easily damaged
Sequoia sempervirens 'Aptos Blue'	Redwood	E	Rapid	90'	30'	H	Blue-green foliage, very rapid growth		
Sophora japonica	Japanese Pagoda Tree	D	Slow	40'	40'	M	Good lawn tree, white flowers		
Tilia cordata	Little Leaf Linden	D	Moderate	50'	30'	H	White flowers, fragrant		

Note: These trees have been selected for their ability to do well in Vacaville. Please feel free to call Park Maintenance @ 469-6510 to talk about tree selection.

* Type D = Deciduous
 E = Evergreen

** Water Use L = Low
 M = Medium
 H = High

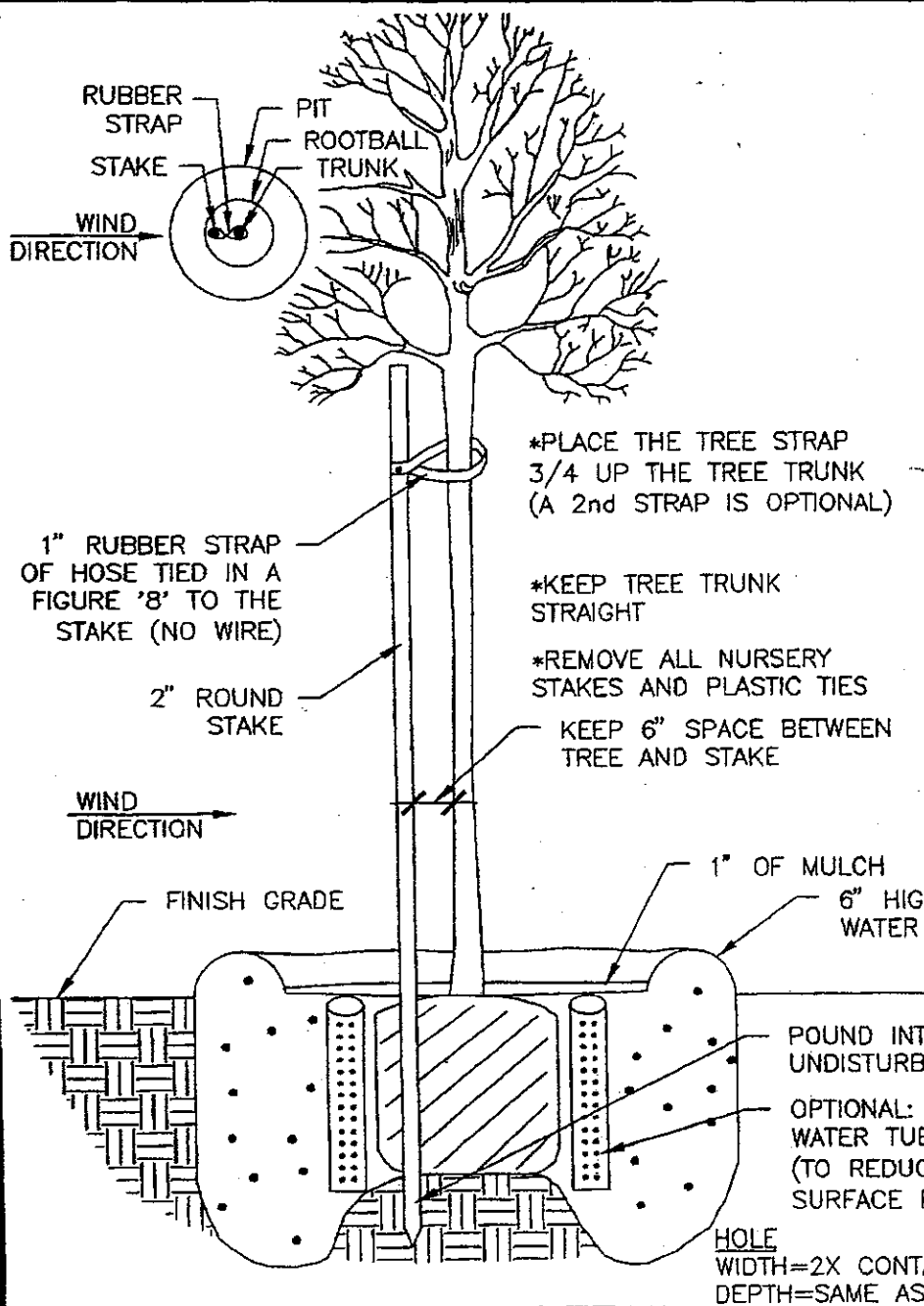

PLANTING DETAIL
FOR A 15 GALLON SIZE TREE

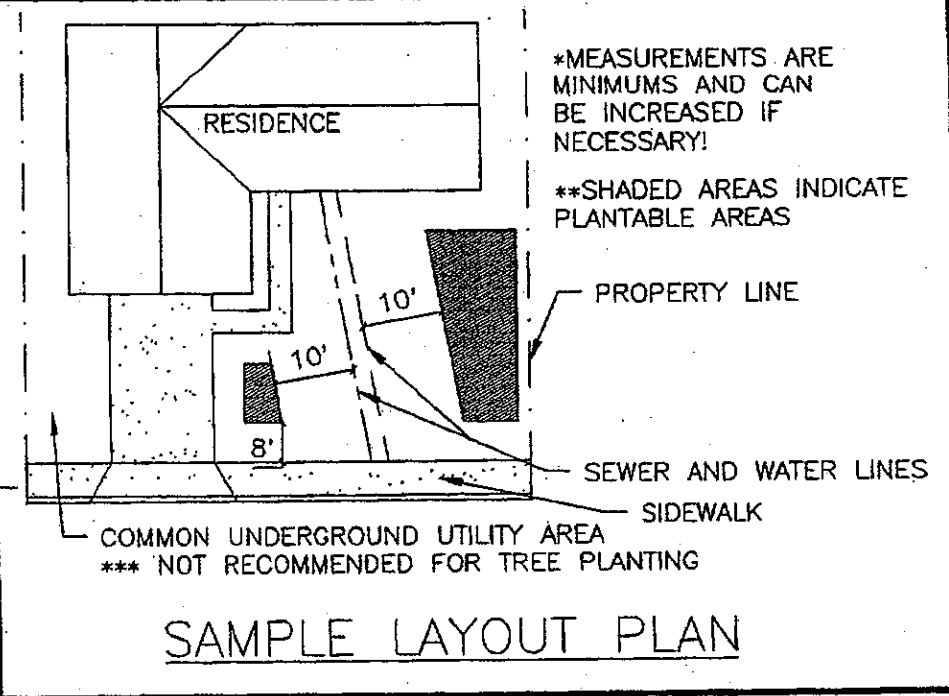

SAMPLE LAYOUT PLAN

PLANTING NOTES:

1. PLANT TOP OF ROOT BALL LEVEL WITH THE FINISH GRADE OUTSIDE THE WATER RING - SEE DETAIL.
2. SOIL AMENDMENT IS OPTIONAL.
3. MULCH THE SOIL SURFACE WITHIN THE WATER RING AND WATER BOTH SLOWLY AND DEEPLY.
4. IF TREE IS PLANTED IN THE LAWN, PLEASE WATER IT DEEPLY IN ADDITION TO LAWN WATERING.
5. IF YOU HAVE ANY QUESTIONS ON TREE PLANTING OR CARE PLEASE CALL PARK MAINTENANCE AT 469-6500.

STREET TREE PLANTING

SCALE: NONE	PUBLIC WORKS DEPT.
DATE: 9/9/99	
DRAWN: N.B.	CITY OF VACAVILLE
REVISED: <i>αS</i>	
APPROVED BY	